



\* The presented performance classes do not necessarily refer to a single specimen. Please contact ETEM Technical Department for specific requests and configurations.

# EW70

## OPENING SYSTEM

A new generation opening window system with thermal break. It provides solutions to several configurations thanks to its wide profile range. It ensures material optimal solutions with exceptionally high testing performances. A special hidden vent solution is supported, as well as integration with shutter or rolling shutter.



### TECHNICAL FEATURES

Frame width:	70mm
Min. frame height:	47mm
Min. casement height (f+v):	74mm / 95mm
Glazing infill range:	8 ÷ 60mm

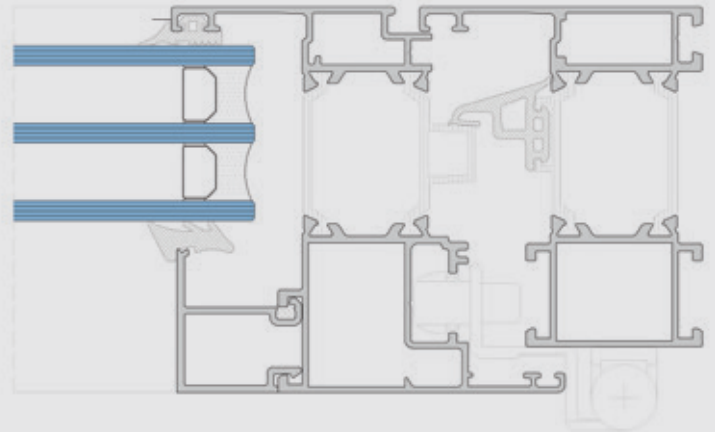

### PERFORMANCE\*

Air permeability:	up to Class 4
Watertightness:	up to Class E750
Resistance to wind load:	up to Class C4
Thermal transmittance ( $U_f$ ):	from 1,2 W/(m <sup>2</sup> K)
Impact resistance:	up to Class 4
Mechanical properties:	Class 2



### TYOLOGIES

- o Turn, tilt & turn, tilt, fixed, door height window, hidden vent
- o Single & double leaf
- o Inward opening

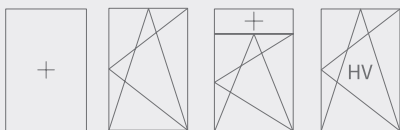

### HARDWARE

Eurogroove & PVC groove  
Max. vent weight: 130kg

### SURFACE TREATMENT

QUALICOAT - Powder coating  
QUALANOD - Anodising  
QUALIDECO - Wood effects