



* The presented performance classes do not necessarily refer to a single specimen. Please contact ETEM Technical Department for specific requests and configurations.

E50

SLIDING SYSTEM

A high-end sliding window system with thermal break. It provides solutions to several configurations thanks to its wide profile range. It supports either lift & slide or sliding mechanism and offers options with flat rail and/or narrow interlock. Integration with flyscreen and/or shutter is available.

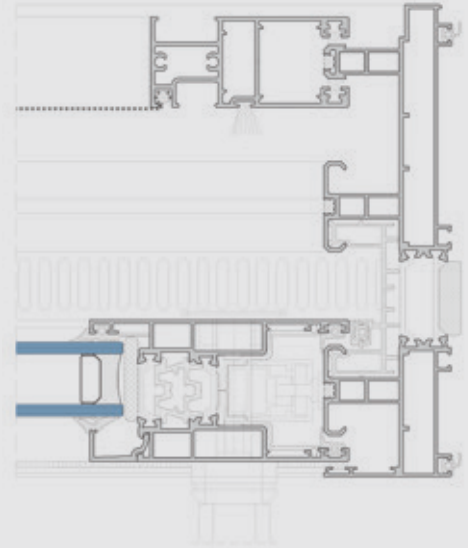

TECHNICAL FEATURES

Sash width:	50mm
Sash height:	80mm / 92mm
Rail height:	30mm / 45mm
Interlock width:	36mm / 112mm
Glazing infill range:	6 ÷ 40mm

PERFORMANCE*

Air permeability:	up to Class 4
Watertightness:	up to Class E1200
Resistance to wind load:	up to Class C3
Thermal transmittance (U_f):	from 2,0 W/(m ² K)
Acoustic performance:	up to 41 dB



TYOLOGIES

- o Single-sash, double-sash, triple-sash & quadruple-sash
- o Sliding, opposed, pocket (in-wall), sliding with fixed light (hotel type) or corner configuration
- o With or without flyscreen and/or shutter

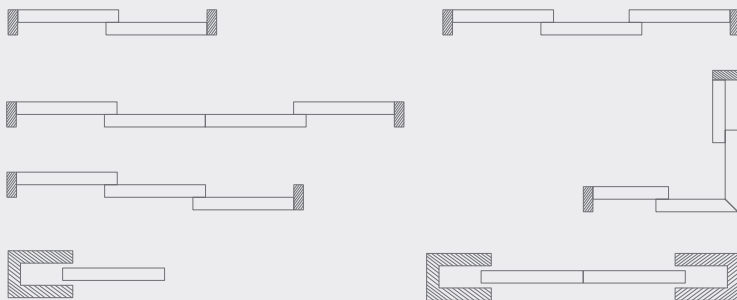

HARDWARE

Slide or Lift & slide mechanism
Stainless steel rail
Max. weight for mechanism: 400kg
Max. height (on demand): 3.300mm
Max. width (on demand): 3.300mm

SURFACE TREATMENT

QUALICOAT - Powder coating
QUALANOD - Anodising
QUALIDECO - Wood effects