

Number	20-003557-PR01 (NW -01-K20-06-en-01)
Owner	ETEM COMMERCIAL AND INDUSTRIAL LIGHT METALS S.A. 1, Iroon Polytechniou Str., 190 18 Magoula Greece
Product	Facade profiles - metal
Designation	System: EF50 CC
Details	Material Aluminium alloy - anodised - painted - powder coated; Projected width 50 mm; Thickness of infill from - to 8 mm – 36 mm; Edge cover of infill 15 mm; Internal insulator: Designation ET080171.00 / ET080172.00 / ET080173.00 / ET080174.00 / ET080518.00; Material Polyvinylchloride unplasticized (PVC-U) / User specific – „Plamaframe“; Support profile – Mullion / Transom; Designation E8050109 / E8050102 / E8050359 / E85350 / E8050105 / E8050353; Structural depth from - to 6 mm - 253 mm; Glazing gasket: Material Ethylene Propylene Diene Monomer (EPDM); Internal glazing gasket: Thickness from - to 3 mm - 12 mm; External glazing gasket: Thickness 5 mm; Pressure plate; Designation E85700; Material Aluminium alloy - untreated; Cover plate; Designation E85718

Special features

## Result

Calculation of thermal transmittance (Radiosity-Method) according to EN ISO 10077-2:2017-07



$$U_0 = 0.91 \text{ W/(m}^2\text{K)} - 3.2 \text{ W/(m}^2\text{K)}$$

ift Rosenheim

30.09.2021



Konrad Huber, Dipl.-Ing. (FH)  
Head of Testing Department  
Building Physics



Till Stübgen, Dipl.-Ing. (FH)  
Operating Testing Officer  
Building Physics

## Basis \*)

EN ISO 10077-2:2017-07  
\*) and corresponding national versions  
e.g. DIN EN)

Test report: 20-003557-PR01  
(PB -01-K20-06-en-01)

## Representation

Exemplary test specimen

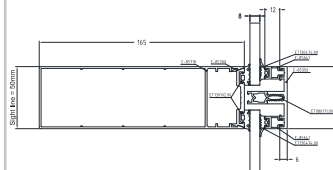

## Instructions for use

The results obtained can be used as evidence in accordance with the above basis.

## Validity

There is no time limit.  
When using this document the up-to-dateness of above basis and the conformity of the product have to be observed.

The data and detailed results given relate solely to the tested/described specimen.

This test does not allow any statement to be made on further characteristics of the present structure regarding performance and quality, in particular the effects of weathering and ageing.

## Notes on publication

The ift-Guidance Sheet "Conditions and Guidance for the Use of ift Test Documents" applies. The document may only be published in full.

Identity-Check



[www.ift-rosenheim.de/ift-geprueft](http://www.ift-rosenheim.de/ift-geprueft)  
ID: 46D-CE8CB

**Type list for calculations of thermal transmittance according to  
 EN ISO 10077-2:2017-07**

**Test result**

Calculated thermal transmittance:

Specimen No.	Description	Projected width $b_f$	Filling thickness $d_p$	$U_0$ <sup>1)</sup>
		in mm	in mm	in $W/(m^2K)$
-01	E-8050109_E-85718 (8 mm)	50	8	3,2
-02	E-8050102_E-85718 (8 mm)	50	8	2,9
-03	E-8050359_E-85718 (8 mm)	50	8	3,2
-04	E-85350_E-85718 (8 mm)	50	8	2,5
-05	E-8050109_E-85718 (10 mm)	50	10	3,0
-06	E-8050102_E-85718 (10 mm)	50	10	2,8
-07	E-8050359_E-85718 (10 mm)	50	10	3,0
-08	E-85350_E-85718 (10 mm)	50	10	2,4
-09	E-8050109_E-85718 (12 mm)	50	12	2,8
-10	E-8050102_E-85718 (12 mm)	50	12	2,6
-11	E-8050359_E-85718 (12 mm)	50	12	2,7
-12	E-85350_E-85718 (12 mm)	50	12	2,2
-13	E-8050109_E-85718 (14 mm)	50	14	2,8
-14	E-8050102_E-85718 (14 mm)	50	14	2,6
-15	E-8050359_E-85718 (14 mm)	50	14	2,7
-16	E-85350_E-85718 (14 mm)	50	14	2,2
-17	E-8050109_E-85718 (16 mm)	50	16	2,6
-18	E-8050102_E-85718 (16 mm)	50	16	2,4
-19	E-8050359_E-85718 (16 mm)	50	16	2,4
-20	E-85350_E-85718 (16 mm)	50	16	2,0
-21	E-8050109_E-85718 (18 mm)	50	18	2,7
-22	E-8050102_E-85718 (18 mm)	50	18	2,5
-23	E-8050359_E-85718 (18 mm)	50	18	2,5
-24	E-85350_E-85718 (18 mm)	50	18	2,1
-25	E-8050109_E-85718 (20 mm)	50	20	2,7
-26	E-8050102_E-85718 (20 mm)	50	20	2,5
-27	E-8050359_E-85718 (20 mm)	50	20	2,5
-28	E-85350_E-85718 (20 mm)	50	20	2,0
-29	E-8050109_E-85718 (22 mm)	50	22	2,5
-30	E-8050102_E-85718 (22 mm)	50	22	2,3
-31	E-8050359_E-85718 (22 mm)	50	22	2,3
-32	E-85350_E-85718 (22 mm)	50	22	1,9
-33	E-8050109_E-85718 (24 mm)	50	24	2,2
-34	E-8050102_E-85718 (24 mm)	50	24	2,1
-35	E-8050359_E-85718 (24 mm)	50	24	2,1
-36	E-85350_E-85718 (24 mm)	50	24	1,8
-37	E-8050109_E-85718 (26 mm)	50	26	1,9
-38	E-8050102_E-85718 (26 mm)	50	26	1,8
-39	E-8050359_E-85718 (26 mm)	50	26	1,9
-40	E-85350_E-85718 (26 mm)	50	26	1,6

No. 20-003557-PR01 (NW -01-K20-06-en-01) dated 30.09.2021  
 Owner (client) ETEM COMMERCIAL AND INDUSTRIAL LIGHT METALS S.A., 190 18 Magoula (Greece)

-41	E-8050109_E-85718 (26 mm / Plamaframe)	50	26	1,2
-42	E-8050102_E-85718 (26 mm / Plamaframe)	50	26	1,2
-43	E-8050359_E-85718 (26 mm / Plamaframe)	50	26	1,2
-44	E-85350_E-85718 (26 mm / Plamaframe)	50	26	1,1
-45	E-8050109_E-85718 (28 mm-9 mm)	50	28	2,0
-46	E-8050102_E-85718 (28 mm-9 mm)	50	28	1,9
-47	E-8050359_E-85718 (28 mm -9 mm)	50	28	1,9
-48	E-85350_E-85718 (28 mm -9 mm)	50	28	1,6
-49	E-8050105_E-85718 (28 mm-9 mm)	50	28	1,9
-50	E-8050353_E-85718 (28 mm-9 mm)	50	28	1,8
-51	E-8050109_E-85718 (28 mm-9 mm / Plamaframe)	50	28	1,2
-52	E-8050102_E-85718 (28 mm-9 mm / Plamaframe)	50	28	1,2
-53	E-8050359_E-85718 (28 mm -9 mm / Plamaframe)	50	28	1,2
-54	E-85350_E-85718 (28 mm -9 mm / Plamaframe)	50	28	1,1
-55	E-8050105_E-85718 (28 mm-9 mm / Plamaframe)	50	28	1,2
-56	E-8050353_E-85718 (28 mm-9 mm / Plamaframe)	50	28	1,2
-57	E-8050109_E-85718 (28 mm-10 mm)	50	28	1,9
-58	E-8050102_E-85718 (28 mm-10 mm)	50	28	1,8
-59	E-8050359_E-85718 (28 mm -10 mm)	50	28	1,8
-60	E-85350_E-85718 (28 mm -10 mm)	50	28	1,6
-61	E-8050105_E-85718 (28 mm-10 mm)	50	28	1,9
-62	E-8050353_E-85718 (28 mm-10 mm)	50	28	1,8
-63	E-8050109_E-85718 (28 mm-10 mm / Plamaframe)	50	28	1,2
-64	E-8050102_E-85718 (28 mm-10 mm / Plamaframe)	50	28	1,1
-65	E-8050359_E-85718 (28 mm -10 mm / Plamaframe)	50	28	1,2
-66	E-85350_E-85718 (28 mm -10 mm / Plamaframe)	50	28	1,1
-67	E-8050105_E-85718 (28 mm-10 mm / Plamaframe)	50	28	1,2
-68	E-8050353_E-85718 (28 mm-10 mm / Plamaframe)	50	28	1,2
-69	E-8050109_E-85718 (28 mm-12 mm)	50	28	2,0
-70	E-8050102_E-85718 (28 mm-12 mm)	50	28	1,9
-71	E-8050359_E-85718 (28 mm -12 mm)	50	28	1,9
-72	E-85350_E-85718 (28 mm -12 mm)	50	28	1,6
-73	E-8050105_E-85718 (28 mm-12 mm)	50	28	2,0
-74	E-8050353_E-85718 (28 mm-12 mm)	50	28	1,8
-75	E-8050109_E-85718 (28 mm-12 mm / Plamaframe)	50	28	1,1
-76	E-8050102_E-85718 (28 mm-12 mm / Plamaframe)	50	28	1,1
-77	E-8050359_E-85718 (28 mm -12 mm / Plamaframe)	50	28	1,2
-78	E-85350_E-85718 (28 mm -12 mm / Plamaframe)	50	28	1,1
-79	E-8050105_E-85718 (28 mm-12 mm / Plamaframe)	50	28	1,1
-80	E-8050353_E-85718 (28 mm-12 mm / Plamaframe)	50	28	1,1
-81	E-8050109_E-85718 (30 mm-9 mm)	50	30	2,0
-82	E-8050102_E-85718 (30 mm-9 mm)	50	30	1,9
-83	E-8050359_E-85718 (30 mm -9 mm)	50	30	1,9
-84	E-85350_E-85718 (30 mm -9 mm)	50	30	1,6
-85	E-8050109_E-85718 (30 mm-9 mm / Plamaframe)	50	30	1,1
-86	E-8050102_E-85718 (30 mm-9 mm / Plamaframe)	50	30	1,1
-87	E-8050359_E-85718 (30 mm -9 mm / Plamaframe)	50	30	1,2
-88	E-85350_E-85718 (30 mm -9 mm / Plamaframe)	50	30	1,1

No. 20-003557-PR01 (NW -01-K20-06-en-01) dated 30.09.2021  
 Owner (client) ETEM COMMERCIAL AND INDUSTRIAL LIGHT METALS S.A., 190 18 Magoula (Greece)



-89	E-8050109_E-85718 (30 mm-10 mm)	50	30	2,0
-90	E-8050102_E-85718 (30 mm-10 mm)	50	30	1,9
-91	E-8050359_E-85718 (30 mm -10 mm)	50	30	1,8
-92	E-85350_E-85718 (30 mm -10 mm)	50	30	1,6
-93	E-8050109_E-85718 (30 mm-10 mm / Plamaframe)	50	30	1,1
-94	E-8050102_E-85718 (30 mm-10 mm / Plamaframe)	50	30	1,1
-95	E-8050359_E-85718 (30 mm -10 mm / Plamaframe)	50	30	1,1
-96	E-85350_E-85718 (30 mm -10 mm / Plamaframe)	50	30	1,1
-97	E-8050109_E-85718 (30 mm-12 mm)	50	30	1,9
-98	E-8050102_E-85718 (30 mm-12 mm)	50	30	1,8
-99	E-8050359_E-85718 (30 mm -12 mm)	50	30	1,8
-100	E-85350_E-85718 (30 mm -12 mm)	50	30	1,5
-101	E-8050109_E-85718 (30 mm-12 mm / Plamaframe)	50	30	1,1
-102	E-8050102_E-85718 (30 mm-12 mm / Plamaframe)	50	30	1,0
-103	E-8050359_E-85718 (30 mm -12 mm / Plamaframe)	50	30	1,1
-104	E-85350_E-85718 (30 mm -12 mm / Plamaframe)	50	30	1,0
-105	E-8050109_E-85718 (32 mm-9 mm)	50	32	1,9
-106	E-8050102_E-85718 (32 mm-9 mm)	50	32	1,8
-107	E-8050359_E-85718 (32 mm -9 mm)	50	32	1,8
-108	E-85350_E-85718 (32 mm -9 mm)	50	32	1,5
-109	E-8050109_E-85718 (32 mm-9 mm / Plamaframe)	50	32	1,1
-110	E-8050102_E-85718 (32 mm-9 mm / Plamaframe)	50	32	1,0
-111	E-8050359_E-85718 (32 mm -9 mm / Plamaframe)	50	32	1,1
-112	E-85350_E-85718 (32 mm -9 mm / Plamaframe)	50	32	1,0
-113	E-8050109_E-85718 (32 mm-10 mm)	50	32	1,6
-114	E-8050102_E-85718 (32 mm-10 mm)	50	32	1,5
-115	E-8050359_E-85718 (32 mm -10 mm)	50	32	1,6
-116	E-85350_E-85718 (32 mm -10 mm)	50	32	1,4
-117	E-8050109_E-85718 (32 mm-10 mm / Plamaframe)	50	32	1,1
-118	E-8050102_E-85718 (32 mm-10 mm / Plamaframe)	50	32	1,0
-119	E-8050359_E-85718 (32 mm -10 mm / Plamaframe)	50	32	1,1
-120	E-85350_E-85718 (32 mm -10 mm / Plamaframe)	50	32	1,0
-121	E-8050109_E-85718 (32 mm-12 mm)	50	32	1,5
-122	E-8050102_E-85718 (32 mm-12 mm)	50	32	1,4
-123	E-8050359_E-85718 (32 mm -12 mm)	50	32	1,4
-124	E-85350_E-85718 (32 mm -12 mm)	50	32	1,3
-125	E-8050109_E-85718 (32 mm-12 mm / Plamaframe)	50	32	1,0
-126	E-8050102_E-85718 (32 mm-12 mm / Plamaframe)	50	32	0,99
-127	E-8050359_E-85718 (32 mm -12 mm / Plamaframe)	50	32	1,0
-128	E-85350_E-85718 (32 mm -12 mm / Plamaframe)	50	32	0,98
-129	E-8050109_E-85718 (34 mm-9 mm)	50	34	1,5
-130	E-8050102_E-85718 (34 mm-9 mm)	50	34	1,4
-131	E-8050359_E-85718 (34 mm -9 mm)	50	34	1,5
-132	E-85350_E-85718 (34 mm -9 mm)	50	34	1,3
-133	E-8050109_E-85718 (34 mm-9 mm / Plamaframe)	50	34	1,0
-134	E-8050102_E-85718 (34 mm-9 mm / Plamaframe)	50	34	1,0
-135	E-8050359_E-85718 (34 mm -9 mm / Plamaframe)	50	34	1,1
-136	E-85350_E-85718 (34 mm -9 mm / Plamaframe)	50	34	0,98

No. 20-003557-PR01 (NW -01-K20-06-en-01) dated 30.09.2021  
 Owner (client) ETEM COMMERCIAL AND INDUSTRIAL LIGHT METALS S.A., 190 18 Magoula (Greece)

-137	E-8050109_E-85718 (34 mm-10 mm)	50	34	1,4
-138	E-8050102_E-85718 (34 mm-10 mm)	50	34	1,4
-139	E-8050359_E-85718 (34 mm -10 mm)	50	34	1,4
-140	E-85350_E-85718 (34 mm -10 mm)	50	34	1,3
-141	E-8050109_E-85718 (34 mm-10 mm / Plamaframe)	50	34	1,0
-142	E-8050102_E-85718 (34 mm-10 mm / Plamaframe)	50	34	0,98
-143	E-8050359_E-85718 (34 mm -10 mm / Plamaframe)	50	34	1,0
-144	E-85350_E-85718 (34 mm -10 mm / Plamaframe)	50	34	0,96
-145	E-8050109_E-85718 (34 mm-12 mm)	50	34	1,4
-146	E-8050102_E-85718 (34 mm-12 mm)	50	34	1,3
-147	E-8050359_E-85718 (34 mm -12 mm)	50	34	1,4
-148	E-85350_E-85718 (34 mm -12 mm)	50	34	1,2
-149	E-8050109_E-85718 (34 mm-12 mm / Plamaframe)	50	34	0,98
-150	E-8050102_E-85718 (34 mm-12 mm / Plamaframe)	50	34	0,95
-151	E-8050359_E-85718 (34 mm -12 mm / Plamaframe)	50	34	1,0
-152	E-85350_E-85718 (34 mm -12 mm / Plamaframe)	50	34	0,94
-153	E-8050109_E-85718 (36 mm-9 mm)	50	36	1,4
-154	E-8050102_E-85718 (36 mm-9 mm)	50	36	1,3
-155	E-8050359_E-85718 (36 mm -9 mm)	50	36	1,4
-156	E-85350_E-85718 (36 mm -9 mm)	50	36	1,2
-157	E-8050109_E-85718 (36 mm-9 mm / Plamaframe)	50	36	0,99
-158	E-8050102_E-85718 (36 mm-9 mm / Plamaframe)	50	36	0,96
-159	E-8050359_E-85718 (36 mm -9 mm / Plamaframe)	50	36	1,0
-160	E-85350_E-85718 (36 mm -9 mm / Plamaframe)	50	36	0,94
-161	E-8050109_E-85718 (36 mm-10 mm)	50	36	1,3
-162	E-8050102_E-85718 (36 mm-10 mm)	50	36	1,3
-163	E-8050359_E-85718 (36 mm -10 mm)	50	36	1,3
-164	E-85350_E-85718 (36 mm -10 mm)	50	36	1,2
-165	E-8050109_E-85718 (36 mm-10 mm / Plamaframe)	50	36	0,97
-166	E-8050102_E-85718 (36 mm-10 mm / Plamaframe)	50	36	0,94
-167	E-8050359_E-85718 (36 mm -10 mm / Plamaframe)	50	36	0,99
-168	E-85350_E-85718 (36 mm -10 mm / Plamaframe)	50	36	0,93
-169	E-8050109_E-85718 (36 mm-12 mm)	50	36	1,3
-170	E-8050102_E-85718 (36 mm-12 mm)	50	36	1,2
-171	E-8050359_E-85718 (36 mm -12 mm)	50	36	1,3
-172	E-85350_E-85718 (36 mm -12 mm)	50	36	1,2
-173	E-8050109_E-85718 (36 mm-12 mm / Plamaframe)	50	36	0,95
-174	E-8050102_E-85718 (36 mm-12 mm / Plamaframe)	50	36	0,92
-175	E-8050359_E-85718 (36 mm -12 mm / Plamaframe)	50	36	0,97
-176	E-85350_E-85718 (36 mm -12 mm / Plamaframe)	50	36	0,91

<sup>1)</sup> Calculated and rounded according to EN ISO 10077-2 using the radiosity method.