

E75

OPENING SYSTEM

A heavy duty opening window system with thermal break, designed to support a large variety of solutions. It provides a wide range of profile options for inward & outward opening windows. Special hidden vent and ventilated vent solutions are available. It can be integrated with shutter and rolling shutter.



TECHNICAL FEATURES

Frame width:	75mm
Min. frame height:	59mm
Min. casement height (f+v):	78mm / 106mm
Glazing infill range:	13 ÷ 65mm

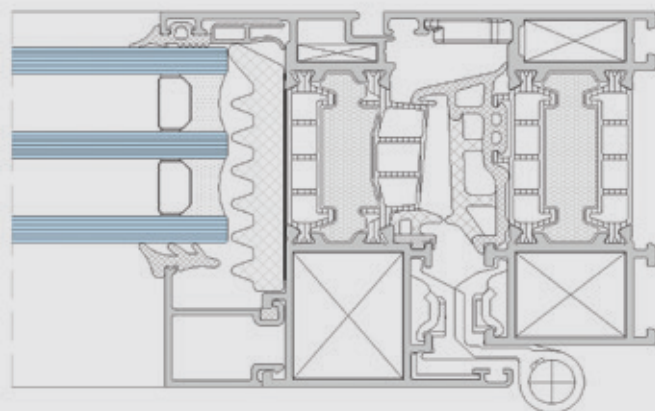

PERFORMANCE*

Air permeability:	up to Class 4
Watertightness:	up to Class E1500
Resistance to wind load:	up to Class C5
Thermal transmittance (U_f):	from 1,2 W/(m ² K)
Acoustic performance:	up to 46 dB
Burglar resistance:	up to Class RC2
Fire resistance:	up to Class EI 60
Impact resistance:	up to Class 3



TYOLOGIES

- o Turn, tilt & turn, tilt, projecting, folding, fixed, parallel sliding, hidden vent
- o Single & double leaf
- o Inward & outward opening

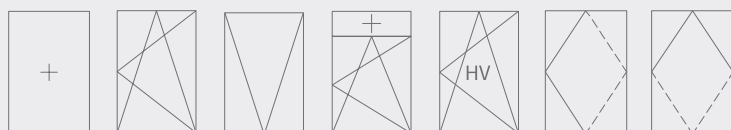

HARDWARE

Eurogroove & PVC groove
Concealed hinges
Max. vent weight: 180kg

SURFACE TREATMENT

QUALICOAT - Powder coating
QUALANOD - Anodising
QUALIDECO - Wood effects