

EW70 Opening Window System

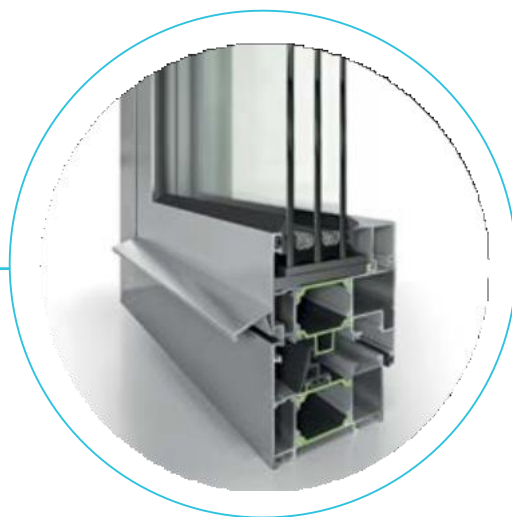

EW 70 is a new generation opening window system with thermal break. It provides solutions to several configurations thanks to its wide profile range. It ensures material optimal solutions with exceptionally high testing performances. A special hidden vent solution is supported, as well as integration with shutter and rolling shutter.

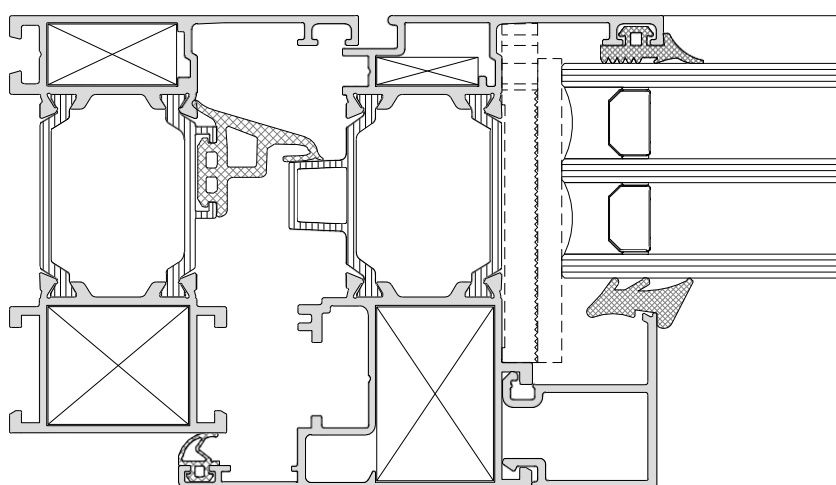

Performance

Air Permeability:	Class 4
Watertightness:	up to Class E750
Resistance to wind load:	up to Class C4
Impact Resistance:	Class 4
Thermal transmittance (U_f):	from 1.2 W/(m ² K)
Operating forces:	Class 1
Mechanical properties:	Class 2

Typologies

- Turn, tilt & turn, tilt, fixed, door-height window
- Inward opening
- Single & double leaf

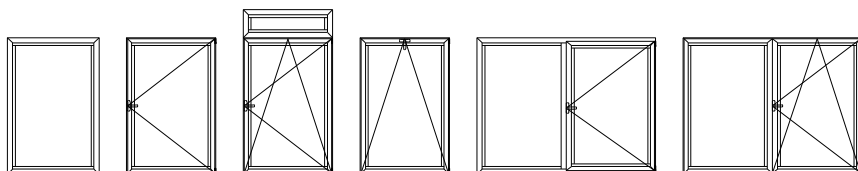

Technical features

Frame width: 70 mm
Min. frame height: 59 mm
Casement height (f+v): 74 mm / 107 mm
Glazing infill range: 17 ÷ 52 mm
Max. vent height: 2.300 mm
Max. vent width: 1.400 mm

Hardware accessories

Eurogroove & PVC groove
Max. leaf weight: 130 kg

Surface treatment options

QUALICOAT - Powder coating
QUALANOD - Anodising
QUALIDECO - Wood effects



Production certificates

- EN ISO 9001
- EN ISO 14001
- OHSAS 18001

